

**PURA**<sup>®</sup> NFC

BY TRESPA

LASTING  
AESTHETICS

---

PURA® NFC  
PU30  
Tropical Ipe

★★★★★🕒  
Lasting  
aesthetics

---

The NFC in Pura® NFC stands for natural fibre core. The high-pressure laminate is made of up to 70% natural fibres, which go through an advanced in-house developed manufacturing process. All Pura® NFC products are certified according to PEFC™ standard.





# PURA<sup>®</sup> NFC

Pura<sup>®</sup> NFC by Trespa clads buildings in enduring elegance – maintaining its beauty and smooth surface in the face of the elements. The premium façade solution is designed to be durable, low maintenance and easily installed.

---

Go to **TRESPA.COM/PuraNFC** to get inspired and see some of our customer stories.



**PURA® NFC**

PU17 Aged Ash

PU24 Mystic Cedar

PU28 Siberian Larch

Individual House, Settimo Torinese, Italy

# Stunning for decades

---



Pura® NFC can stand out as an architectural element or harmonise with landscapes and other building materials. Its closed surface minimises dirt build-up and makes the sidings easy to clean. It keeps buildings looking good for decades.

# High impact and scratch resistance

---

PURA® NFC BY TRESPA



PURA® NFC  
PU22 Slate Ebony



## Durable as a diamond

The façade protects what's behind it. But what protects the façade? Pura® NFC uses next-generation Electron Beam Curing (EBC) technology to create a closed and smooth surface. The system is built for rough weather and has a high impact and scratch resistance. The built-in colour stability means Pura® NFC will look good for years without any replacement pieces or sprucing up.



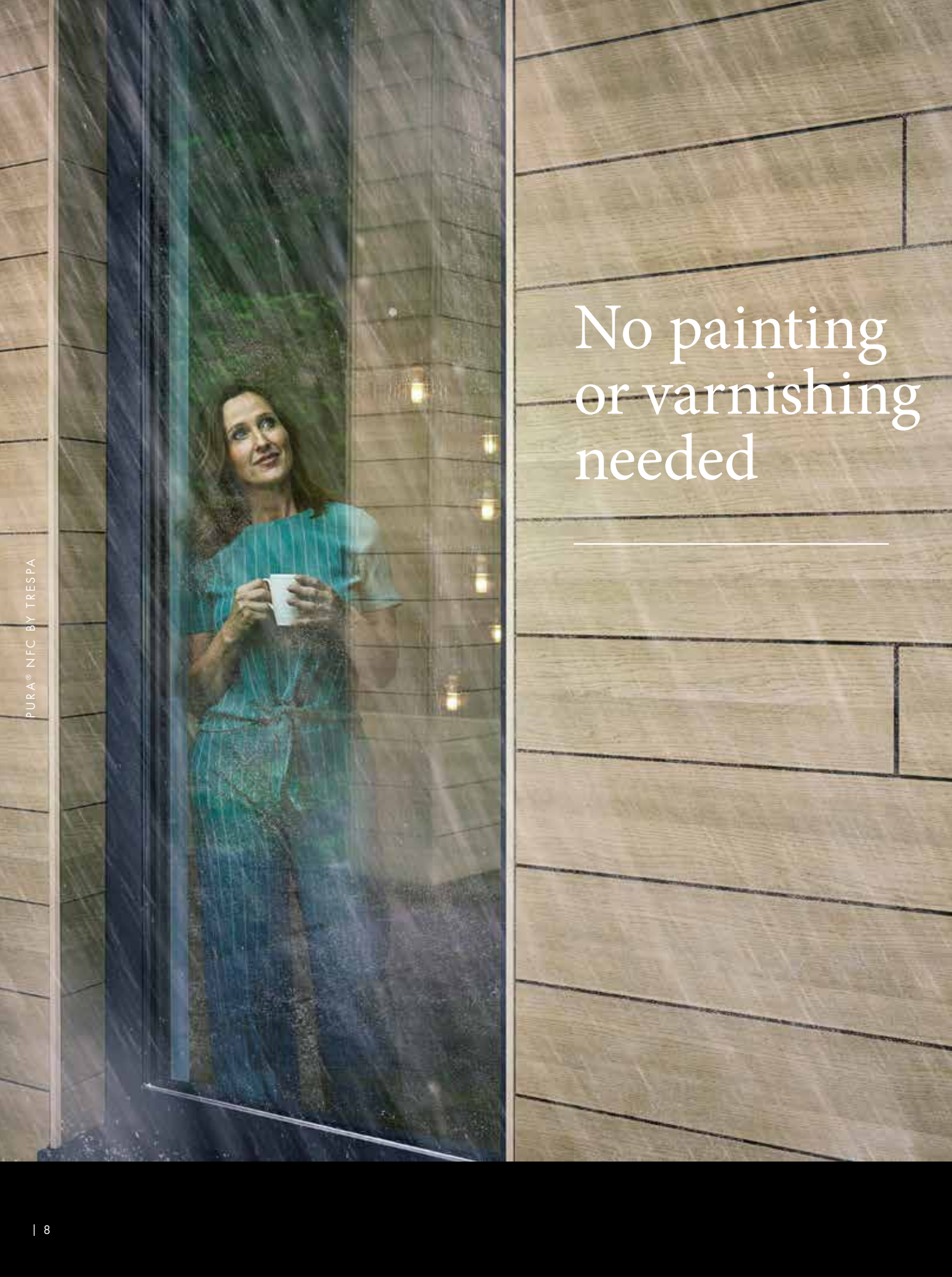

No painting  
or varnishing  
needed

---

PURA® NFC BY TRESPA



# No worries about maintenance

It's wonderful to live or work in a beautiful building. It's less wonderful to climb on a ladder to scrub it every month. Pura® NFC's closed surface prevents dirt from building up, making cleaning easy and infrequent. Contaminants like soot, graffiti and permanent markers are easy to remove. Buildings keep their vibrant beauty year after year, without paintbrushes. It's yet another way that buildings with Pura® NFC façades give owners less to worry about.

**PURA® NFC**  
PU02 Classic Oak



The closed surface created by Trespa's proprietary Electron Beam Curing (EBC) technology makes it hard for dirt to build up, locking it out and colours in.



**PURA® NFC**

PU17 Aged Ash  
PU24 Mystic Cedar  
PU28 Siberian Larch

**TRESPA® METEON®**

NM04 Sintered Alloy

Private house, Dartmouth, United Kingdom

Sidings are intended to  
be outdoors, after all

---



PURA® NFC BY TRESPA

Whether it's salty sea air, wind, rain, humidity or intense sunlight, Pura® NFC stands up to the weather. Each Pura® NFC sample undergoes many laboratory tests where it's exposed to damaging climate elements, then checked to confirm it's maintained its vibrancy and polish. Imagine a stylish wooden palazzo that remains richly hued in Florida's humid year-round sunshine or a tranquil seaside home without the need for constant repair. The Pura® NFC system is engineered to stay pristine.

Whether it's atop a mountain  
or adorning your garden home,  
Pura<sup>®</sup> NFC looks beautiful  
anywhere - and everywhere!

---

FOLLOW MY ADVENTURES!

#FOLLOWTHEHUB



PURA® NFC BY TRESPA

**PURA® NFC**  
PUL9000 Metropolis Black





Recently, our gardens have become our sanctuaries, our party rooms and our playrooms. Holiday homes, on the other hand, have always been an escape to calm, whether surrounded solely by nature or a park with amenities and activities. Whatever use the buildings are put to, a façade built with Pura® NFC will enhance the beauty of a property.

Pura® NFC is an enduringly beautiful siding with engineered durability and a range of luxurious decors, from textured Siberian larch to the dark velvety texture of Pura® NFC Lumen.

The beauty of Pura® NFC siding is that you can install it and forget it. It stays pristine for decades, so you have no worries about maintenance. Make your holiday home or garden building a source of joy - not chores - for everyone!



PURA® NFC  
PU02 Classic Oak

# Harmonising with nature

---



# A rich palette of colours

- NEW** [PUL0500 Athens White](#)
- [PUL2581 New York Grey](#)
- [PUL9000 Metropolis Black](#)

## LUMEN

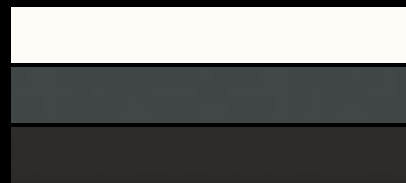

Pura® NFC Lumen gently diffuses light for a modern or ethereal look. Its low reflection of light gives the façade a smooth matt appearance.

- [PU02 Classic Oak](#)
- NEW** [PU14 French Walnut](#)
- NEW** [PU31 Western Red Cedar](#)
- [PU08 Romantic Walnut](#)
- [PU30 Tropical Ipe](#)
- [PU28 Siberian Larch](#)
- [PU24 Mystic Cedar](#)
- [PU17 Aged Ash](#)
- [PU22 Slate Ebony](#)

## WOOD DECORS



**PURA® NFC** Lumen  
PUL9000  
Metropolis Black





**PURA**® NFC

## Siding collection

Pura® NFC comes with a tailored collection of installation clips, colour-matched profiles and fasteners - everything needed to create an evenly hued façade. Every detail can look exactly as it was designed to. The sidings come prefinished, but if they need to be fitted for a dormer or eaves, the strength of Pura® NFC means installers can saw without splinters or shattering. Also, the edges don't need sealing – the durability and hue go all the way through. Corners stay sharp and flats stay smooth.

**PURA® NFC**  
PU24  
Mystic Cedar

A construction worker wearing a white hard hat and a dark plaid shirt is shown in profile, looking towards the right. He is touching a wall made of vertical wood-grain panels. The background is a bright, sunny outdoor scene with green trees.

Easily installed,  
never redone

---

# No-fuss installation

Pura® NFC is engineered to be used in a ventilated façade solution that's easily installed. The relatively low weight of the prefinished sidings makes them easy to slide into place and their durability means they can handle a rough build site. The combination of durability and ventilation helps Pura® NFC withstand challenging climates.

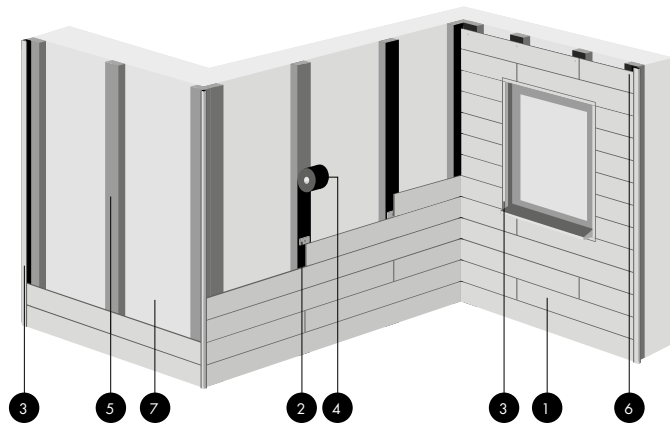

1. Pura® NFC siding
2. Pura® NFC clip
3. Colour-matched profile
4. EPDM
5. Subframe
6. Colour-matched fasteners
7. Load-bearing wall
8. Ventilation airflow

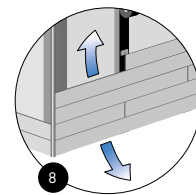
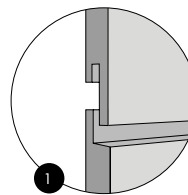



The system includes an air cavity in front of the load-bearing wall, allowing an airflow that prevents heat or moisture accumulation.

*This sketch is intended as a general overview only.*



Scan the QR code for a video on installation. For specifics about fixing solutions, please visit our website **TRESPA.INFO**.

# Delivery programme

	LUMEN	COLOUR CODE	COLOUR NAME	CORE		FINISH
				Brown	Black	Diffuse
<b>NEW</b>		PUL0500	Athens White		•	•
		PUL2581	New York Grey		•	•
		PUL9000	Metropolis Black		•	•

	WOOD DECORS	COLOUR CODE	COLOUR NAME	CORE		FINISH
				Brown	Black	Matt
		PU02	Classic Oak	•		•
<b>NEW</b>		PU14	French Walnut	•		•
<b>NEW</b>		PU31	Western Red Cedar	•		•
		PU08	Romantic Walnut	•		•
		PU30	Tropical Ipe	•		•
		PU28	Siberian Larch	•		•
		PU24	Mystic Cedar	•		•
		PU17	Aged Ash	•		•
		PU22	Slate Ebony		•	•

## SPECIAL REQUEST

Looking for different colours? Pura® NFC is available in a wide range of Trespa® colours and decors. For more information, please contact your local Trespa representative.



Order samples at  
**TRESPA.COM/PuraNFC.**

## PREFINISHED SIDINGS

SIDING		PACK		FULL PALLET	
Size	3050 x 186 x 8 mm	Quantity	4 Sidings	Quantity	144 Sidings / 36 packs
Surface (gross)	0,57 m <sup>2</sup>	Weight indication	26 kg		
Surface (net)	0,55 m <sup>2</sup>				

## FASTENERS AND MATCHING ACCESSORIES

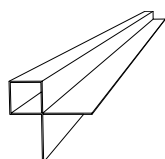

Proface®  
outer-corner profile

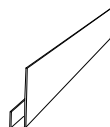

Proface®  
finish profile

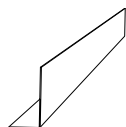

Proface®  
support profile\*



Ipex universal  
ventilation profile\*\*

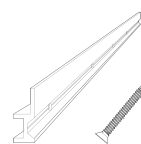

Ipex universal starter rail  
and matching SFS screw\*\*



Universal clip and  
matching SFS screw



SFS  
profile screws

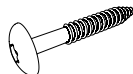

SFS  
HPL fast fixing screws



SFS  
rivet



SFS Self-Flex EPDM joint tape  
25 m x 0,8 x 70 mm  
25 m x 0,8 x 130 mm

\*only available in black core, brown core | \*\*only available in black

## PROFILES, HPL SCREWS AND RIVETS ARE AVAILABLE IN THE FOLLOWING COLOURS:



Classic Oak  
(PU02)



French Walnut  
(PU14)



Western  
Red Cedar  
(PU31)



Romantic  
Walnut  
(PU08)



Tropical Ipe  
(PU30)



Siberian Larch  
(PU28)



Aged Ash (PU17)/  
Mystic Cedar (PU24)



Brown core



Black core



Slate Ebony  
(PU22)



New York Grey  
(PUL2581)



Metropolis Black  
(PUL9000)



Athens White  
(PUL0500)

For specifics about fixing solutions, please visit our website [TRESPA.INFO](https://www.trespa.info).

## TRESPA - THE ARCHITECTS' CHOICE FOR OVER 60 YEARS

Pura® NFC is designed and created by Trespa, a specialist in panelling and siding headquartered in the Netherlands. Founded in 1960, Trespa is the first choice in exterior panelling for many of the world's leading architects, who insist on quality, reliability and durability for their projects.



## CONTACT US

### TRESPA INTERNATIONAL B.V.

P.O. Box 110, 6000 AC Weert  
Wetering 20, 6002 SM Weert  
The Netherlands  
www.trespa.com

### UNITED KINGDOM & IRELAND

#### TRESPA UK LTD.

Coast Road  
North Shields  
Tyne & Wear, NE29 8RE  
United Kingdom  
Tel: 0808-2340268  
Info.UK@Trespa.com

### EMEA & APAC EXPORT CUSTOMER SERVICE DESK

Tel: +31 (0) 495 458 839  
Info.Export@Trespa.com

## VISIT US

### TRESPA DESIGN CENTRE WEERT

Wetering 20  
6002 SM Weert  
The Netherlands  
Tel: +31 (0) 495 458 845  
Info.Nederland@Trespa.com  
www.trespa.com

### TRESPA DESIGN CENTRE BARCELONA

Calle Ribera 5,  
08003 Barcelona  
Spain  
Tel: +34 (0) 93 295 4193  
Info.Iberia@Trespa.com  
www.trespa.com

## FOLLOW US



## DISCLAIMER

### GENERAL

These terms apply to the use of this document and such use automatically means that the other party agrees to these terms. The information provided by Trespa International B.V. ("Trespa") in this document is solely indicative. Trespa is unable to warrant the accuracy and completeness of this information. Trespa may change the information included in this document at any time and without further notice. Trespa's customers and third parties must ascertain that they have the most recent document (for the most recent version, please consult: [www.trespa.com](http://www.trespa.com)). No rights can be derived from the information provided; the use of the information is at the other party's risk and responsibility. Trespa does not warrant that the information in this document is suitable for the purpose for which it is consulted by the other party. This document does not contain any design, structural calculation, estimate or other warranty or representation that customers and third parties may rely on. This document does not guarantee any properties of Trespa products. Colours used in Trespa's communications (including but not limited to printed matter) and in samples of Trespa's products may differ from the colours of the Trespa products to be supplied. Samples are not intended for use in product tests and are not representative of characteristics of the Trespa

products. Trespa's products and samples are produced within the specified colour tolerances and the colours (of production batches) may differ, even if the same colour is used. The viewing angle also influences the colour perception. Metallics panels feature a surface whose colour appears to change based on the direction from which it is viewed. The specified colour stability and colour specifications relate only to the decorative surface of the Trespa products, not to the core material and samples of the Trespa products. Trespa products are delivered ex-works with straight, sawn sides. Customers and third parties must have a professional adviser inform them about (the suitability of) the Trespa products for all desired applications and about applicable laws and regulations. Trespa does not warrant the above. The most recent version of the current delivery programme and the Material Properties Datasheet can be found at [www.trespa.info](http://www.trespa.info). Only the information in the most recent and valid Material Property Datasheet should be used to select and provide advice regarding Trespa products. Trespa reserves the right to change (the specifications for) its products without prior notice.

### LIABILITY

Trespa is not liable (neither contractual nor non-contractual) for any damage arising from or

related to the use of this document, except if and to the extent that such damage is the result of wilful misconduct or gross negligence on the part of Trespa and/or its management. The limitation of liability applies to all parties affiliated with Trespa, including but not limited to its officers, directors, employees, affiliated enterprises, suppliers, distributors, agents, and representatives.

### GENERAL CONDITIONS

All oral and written statements, offers, quotations, sales, supplies, deliveries and/or agreements and all related activities of Trespa are governed by the Trespa General Terms and Conditions of Sale (*Algemene verkoopvoorwaarden Trespa International B.V.*) filed with the Chamber of Commerce and Industry for Noord- en Midden-Limburg in Venlo (NL) on May 9th, 2023 under number 24270677, which can be found on and downloaded from the Trespa website, [www.trespa.com/documentation](http://www.trespa.com/documentation). All oral and written statements, offers, quotations, sales, supplies, deliveries and/or agreements and all related work of Trespa North America, Ltd. are governed by the Trespa North America General Terms and Conditions of Sale, which can be found on and downloaded from the Trespa website, [www.trespa.com/documentation](http://www.trespa.com/documentation). A copy of these general conditions of sale will be provided free of

charge on request. All general terms and conditions other than the conditions mentioned above are dismissed and do not apply, regardless of whether such terms and conditions are referred to on requests for offers, offer confirmations, stationery and/or other documents of the other party, even if Trespa does not expressly object to such terms and conditions.

### INTELLECTUAL PROPERTY

All intellectual property rights and other rights regarding the content of this document (including logos, text and photographs) are owned by Trespa and/or its licensors. Any use of the content of this document, including distribution, reproduction, disclosure, storage in an automated data file or the dispatch of such a file without Trespa's prior written consent is explicitly prohibited.

\* Trespa, Meteon, Athlon, TopLab, TopLab<sup>PLUS</sup>, TopLab<sup>PLUS ALIGN</sup>, TopLab<sup>ECO-FIBRE</sup>, TopLab<sup>VERTICAL</sup>, TopLab<sup>BASE</sup>, Virtuon, Izeon, Pura, Pura NFC, Volkern, Trespa Essentials and Mystic Metallics are registered trademarks of Trespa.

### QUESTIONS

Should you have any questions or comments, please do not hesitate to contact Trespa.

